





The unique hinge Soft-close® system for doors



Soft-close®



MEPLA  **ALFIT**
Feel the motion !

Summary

		Page
	Soft-close® CST <ul style="list-style-type: none"> • For hinges CSTo4, CST o5, CST 22 and CST 29 • Quick and easy tool-less installation 	4
	Soft-close® CS <ul style="list-style-type: none"> • For hinges CSo4, CS o5, CS 22 and CS 29 • Quick and easy tool-less installation 	8
	Soft-close® F65 <ul style="list-style-type: none"> • For hinges CST 65 und CS 65 • Quick and easy tool-less installation 	12
	Soft-close® Mirro <ul style="list-style-type: none"> • For hinges Mirro and Mirro -15° • Quick and easy tool-less installation 	13

		Page
	Soft-close® ACC • For face frame doors	14
	Soft-close® AL • For aluminium frame doors	16

Elegant design and fascinating engineering.
The perfect combination of the hinge series CST Twin NT
with Soft-close® CST.



Feel like something quiet? Then use Soft-close® CST.
Experience – how doors move in a floating motion.

The future is entering into all furniture. Either kitchen, bath or furniture, Soft-close® CST can be installed immediately or be mounted onto CST Twin NT after the hinge is already installed. Fast, secure and completely toolless. The number of Soft-close® CST installed depends on the door size and weight. Please use the recommended data from the chart.

Twin NT hinges and Soft-close® CST are the perfect match in functionality. The system indicates directions by the harmonizing perfect design. The design developed by Mepla-Alfit is unique and defines a new closing of doors: The motion of the doors is softly slowed down and the door self closes softly and quiet – the perfect balance between form and function.

Soft-close® CST – quick and easy to install.



Mounting is toolless, easy and quick:



Please check:

Are locator pins attached to the hinge cup?

- 1 Take door off the cabinet, remove cover cap (if installed) on oo cranking hinges , open flap of hinge cup.
- 2 Insert Soft-close® CST adapter onto locator pins which are attached to the hinge cup.
- 3 Close Twin NT flap of hinge cup completely.
- 4 Insert Soft-close® damper completely into Soft-close® adapter with the flattened side pointing down.
Click-on cabinet door to mounting plates.
Mount cover cap on hinge if desired (cover cap is included in set).
- 5 Adjust Soft-close® CST to different opening angles and cranking if necessary via adjustment screw.

Soft-close® CST

Suitable for CST o4, CST o5, CST 22, and CST 29 hinges

Soft-close® CST Set

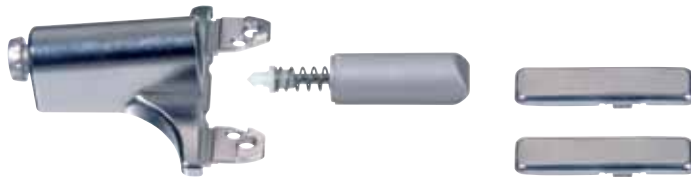

1 Set consisting of:
1 Soft-close® CST adapter
1 Soft-close® CST damper
2 Hinge arm cover caps

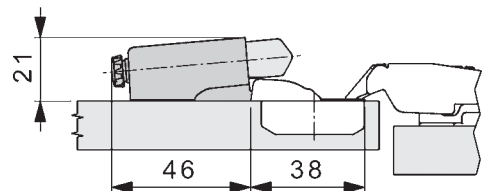

Ref. No.

924.200.41.0115

PU 125 set

Soft-close® CST Adapter

Soft-close® damper



Ref. No.

924.200.41.0015

PU 125 pcs.

Ref. No.

924.012.50.0142

PU 125 pcs.

Cover caps

For hinge cranking o0

For hinge cranking o8 and 15



Ref. No.

514.300.21.0115 nickel plated, unprinted

PU 125 pcs.

514.300.21.0215 nickel plated, unprinted

PU 1000 pcs.



Ref. No.

514.300.22.0015 nickel plated, unprinted

PU 1000 pcs.

PU = Packing unit

Technical Information

-  Position for Soft-close® CST
-  Position for additional Soft-close® CST (recommended)

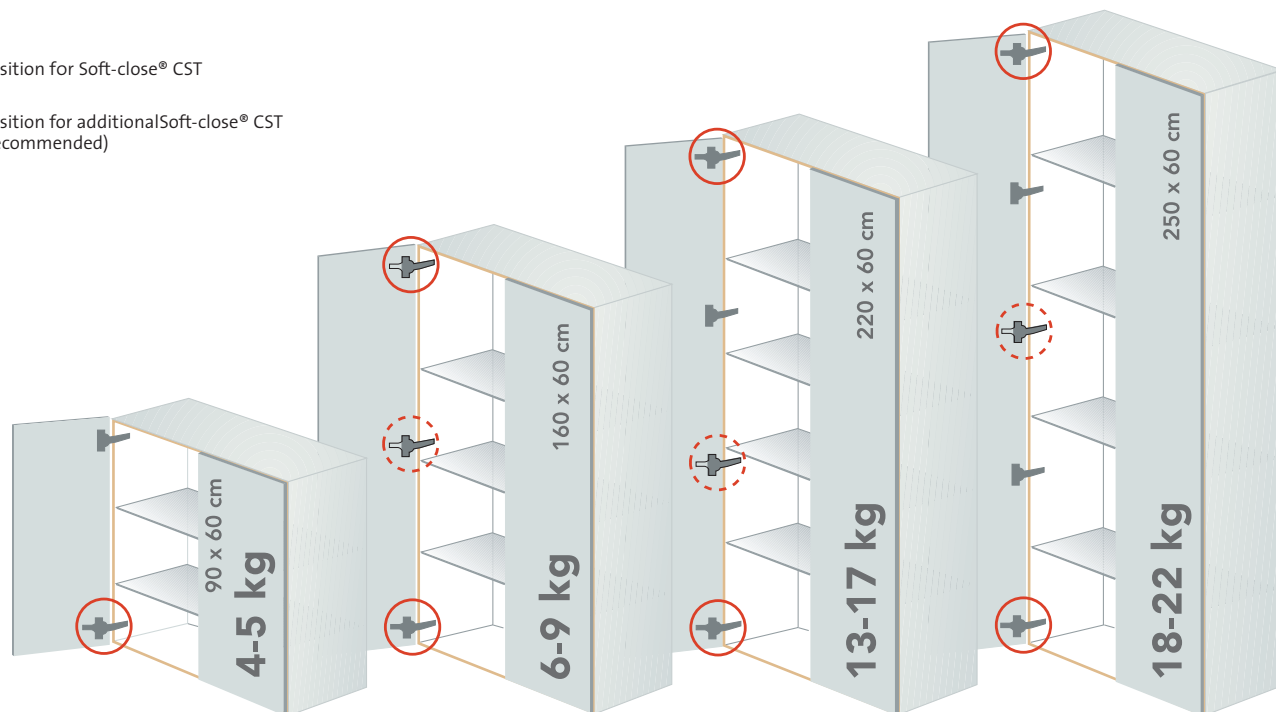

The installing of our furniture fittings must comply with the Mepla-Alfit instructions that are stated in our available sales brochures, otherwise Mepla-Alfit can't be held liable. If further information on installation and assembly is needed, please contact one of our factories directly.

Thank you for your understanding.

Warning

Usage of low grade board material or furniture doors undergoing constant rough usage, the screwing of the adapter with screws \varnothing 3 mm is recommended.

Soft-close® CST is not recommended for frame door application.

Elegant design and fascinating engineering.
The perfect combination of the hinge series CS Click-on
with Soft-close® CS.



Feel like something quiet? Then use Soft-close® CS.
Experience – how doors move in a floating motion.

The future is entering into all furniture. Either kitchen, bath or furniture, Soft-close® CS can be installed immediately or be mounted onto CS Click-on after the hinge is already installed. Fast, secure and completely toolless. The number of Soft-close® CS installed depends on the door size and weight. Please use the recommended data from the chart.

A matching hinge cup cover cap for the CS Click-on hinges without Soft-close® CS underlines perfectly the elegant design. The design developed by Mepla-Alfit is unique and defines a new closing of doors: The motion of the doors is softly slowed down and the door self closes softly and quiet – the perfect balance between form and function.

Soft-close® CS – quick and easy to install.



Mounting is toolless, easy and quick:



Please check:

Are notches located on both sides of the hinge cup?

- 1 Take door off the cabinet, place it horizontal on a stable surface. Remove cover cap (if installed) on oo cranking hinges.
- 2 Insert Soft-close® CS adapter into notches located on the sides of the hinge cup and attach adapter.
- 3 Press both sides of the adapter downwards until you hear a noticeable “click”.
- 4 Mount cover cap on hinge if desired (cover cap is included in set).
- 5 Adjust Soft-close® CS to different opening angles and cranking if necessary via adjustment screw.
- 6 Use cover for hinge cup (included in set) for the hinge without Soft-close® CS to achieve a uniform appearance.

Soft-close® CS

For hinges CS04, CS 05, CS 22 and CS 29

Soft-close® CS Set

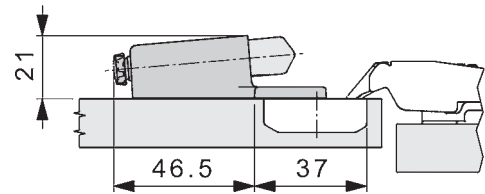

1 Set consisting of:
 1 Soft-close® CST adapter with pre-mounted Soft-close®
 1 Hinge cup cover cap CS
 2 Hinge arm cover caps

Ref. No.
 924.200.40.0115
 PU 125 set

Soft-close® CS Adapter

With pre-mounted Soft-close®



Ref. No.
 924.200.40.0215
 PU 125 pcs.

Cover cap for CS hinge cup



Ref. No.
 514.300.20.0115 steel, nickel plated
 PU 125 pcs.

Cover caps

For hinge cranking 00



Ref. No.
 514.300.21.0115 nickel plated, unprinted
 PU 125 pcs.
 514.300.21.0215 nickel plated, unprinted
 PU 1000 pcs.



For hinge cranking 08 and 15



Ref. No.
 514.300.22.0015 nickel plated, unprinted
 PU 1000 pcs.

PU = Packing unit

Technical Information

-  Position for Soft-close® CS
-  Position for additional Soft-close® CS (recommended)

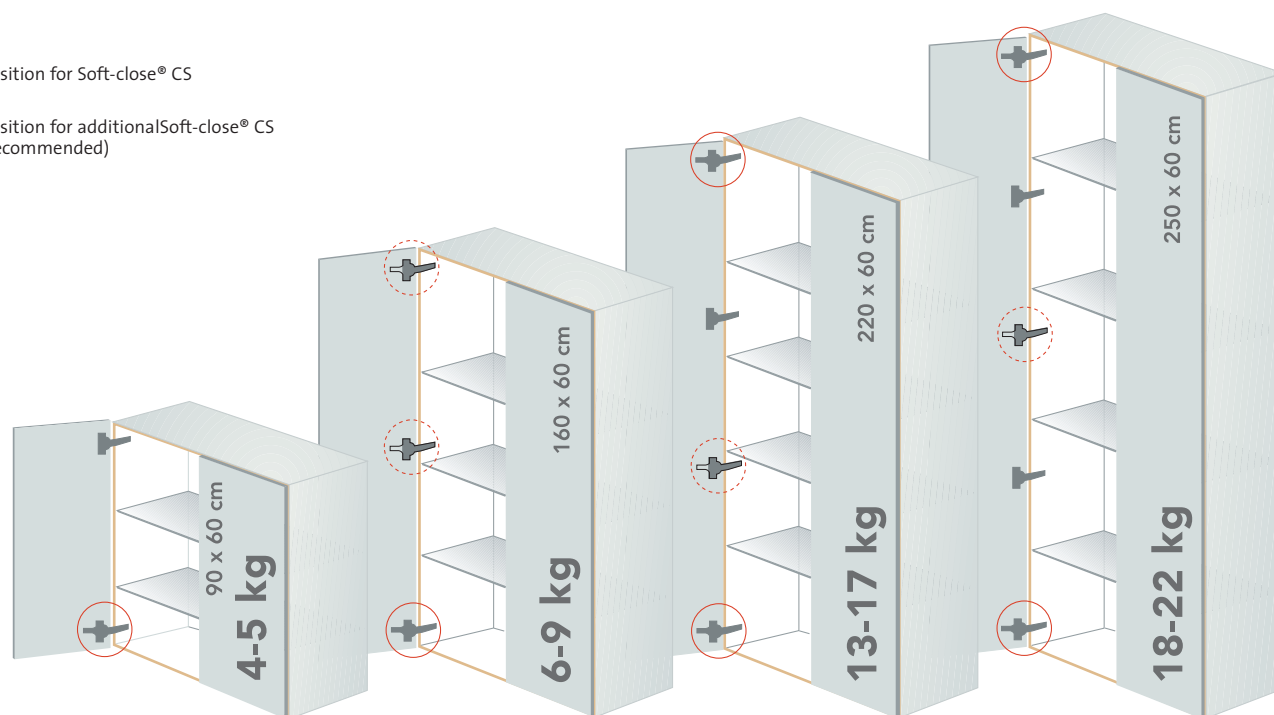

The installing of our furniture fittings must comply with the Mepla-Alfit instructions that are stated in our available sales brochures, otherwise Mepla-Alfit can't be held liable. If further information on installation and assembly is needed, please contact one of our factories directly.

Thank you for your understanding.

Soft-close® F65

Suitable for hinges CST 65 and CS 65

Soft-close® F65



Soft-close® F65
with CST 65 hinge

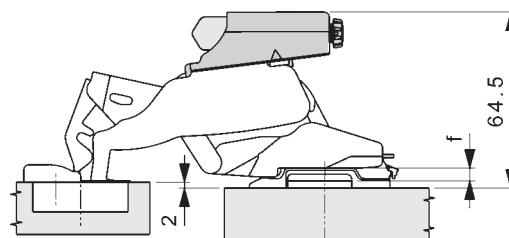

Soft-close® F65
with CS 65 hinge

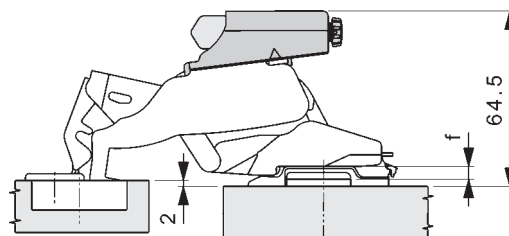

Drawing with mounting plate, thickness 02





Ref. No.

924.200.39.0215

PU 125 pcs.

Technical Information

-  Position für Soft-close® CS
-  Position for additional Soft-close® F65 (recommended)

The installing of our furniture fittings must comply with the Mepla-Alfit instructions that are stated in our available sales brochures, otherwise Mepla-Alfit can't be held liable. If further information on installation and assembly is needed, please contact one of our factories directly.

Thank you for your understanding.

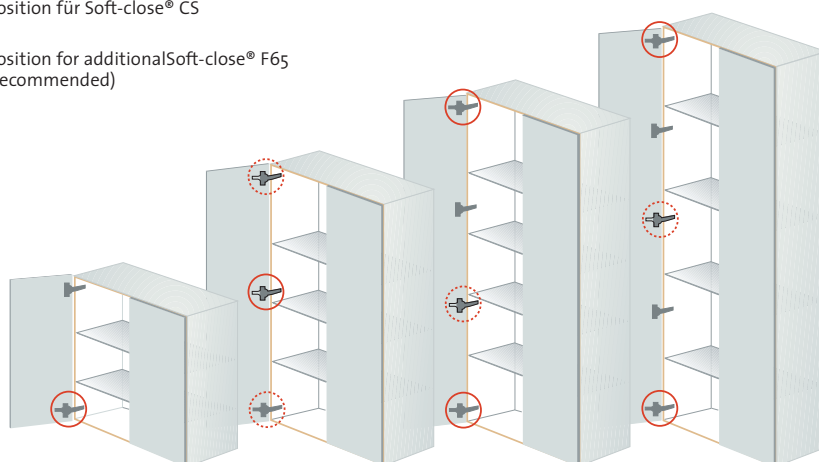

PU = Packing unit



For CS 07 Mirro and CS 07 Mirro 15° negative angle hinges

Soft-close® Mirro



Soft-close® Mirro
with Mirro hinge

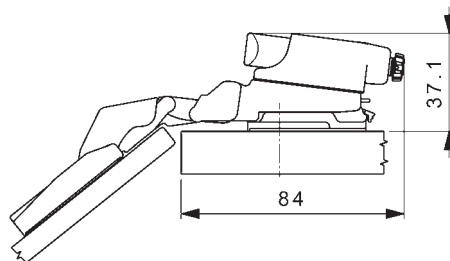

Soft-close® Mirro
with Mirro -15° hinge

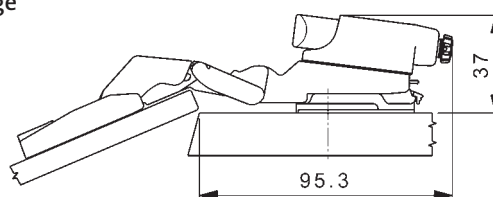

Drawing with mounting plate, thickness 02

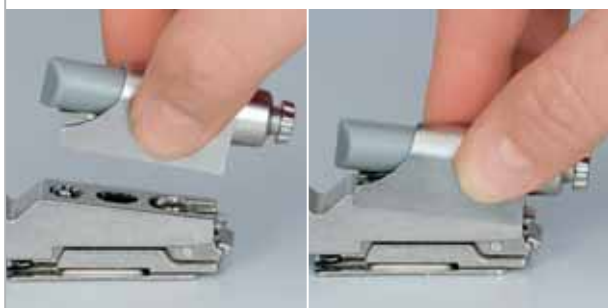

Ref. No.

924.200.38.0215

PU 50 pcs.

Technical Information



Position for Soft-close® Mirro



Position for additional Soft-close® Mirro
(recommended)

The installing of our furniture fittings must comply with the Mepla-Alfit instructions that are stated in our available sales brochures, otherwise Mepla-Alfit can't be held liable. If further information on installation and assembly is needed, please contact one of our factories directly.

Thank you for your understanding.

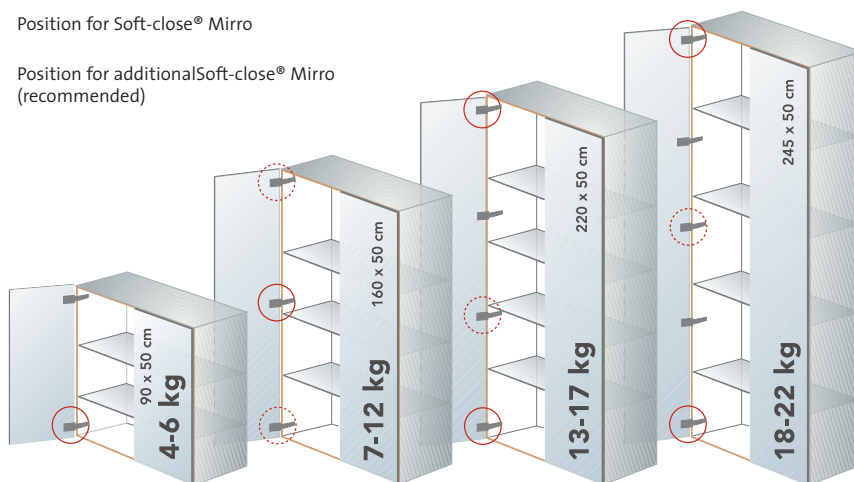

PU = Packing unit

Soft-close® ACC

For frame doors

Soft-close® ACC



- For wooden and aluminium frame doors
- Soft-close characteristic can be adjusted
- Simple assembly
- Invisible from the outside
- Elegant design



Ref. No.
924.200.36.0215
PU 125 pcs.

Cover cap	Counter part, universal	
	 suitable for use with all crankings	
Ref. No. 514.000.85.0115 Plastic, nickel plated 514.000.86.0115 Plastic, nickel plated with Mepla-Alfit Logo PU 125 pcs.	Ref. No. 514.200.60.0115 Zinc die-cast, nickel plated PU 125 pcs.	

PU = Packing unit

Technical Information

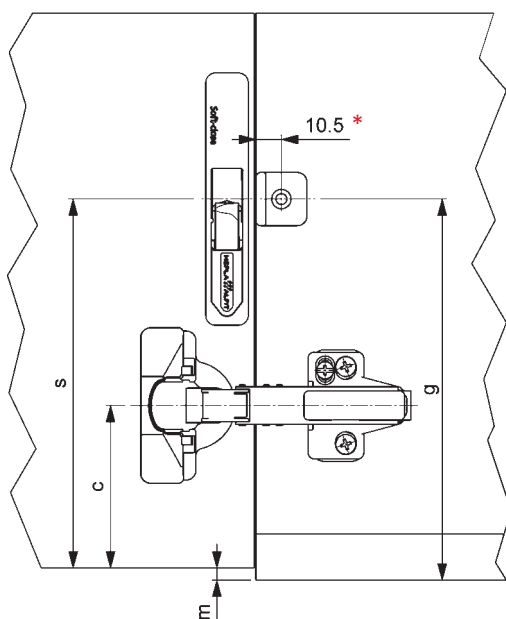
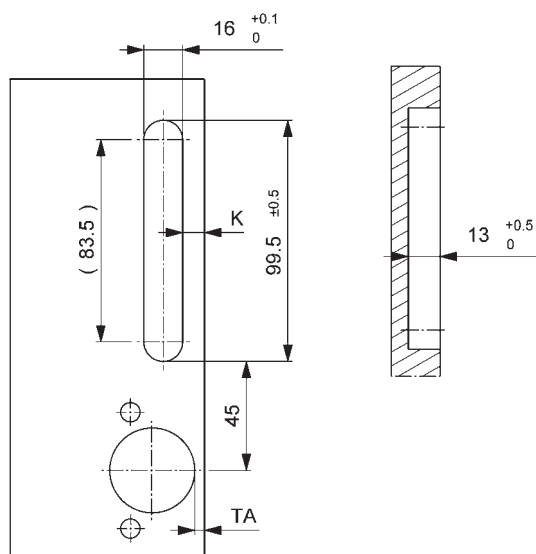

$$g = s + m$$

* Position for inset door:
10,5 mm + door thickness + 2 mm

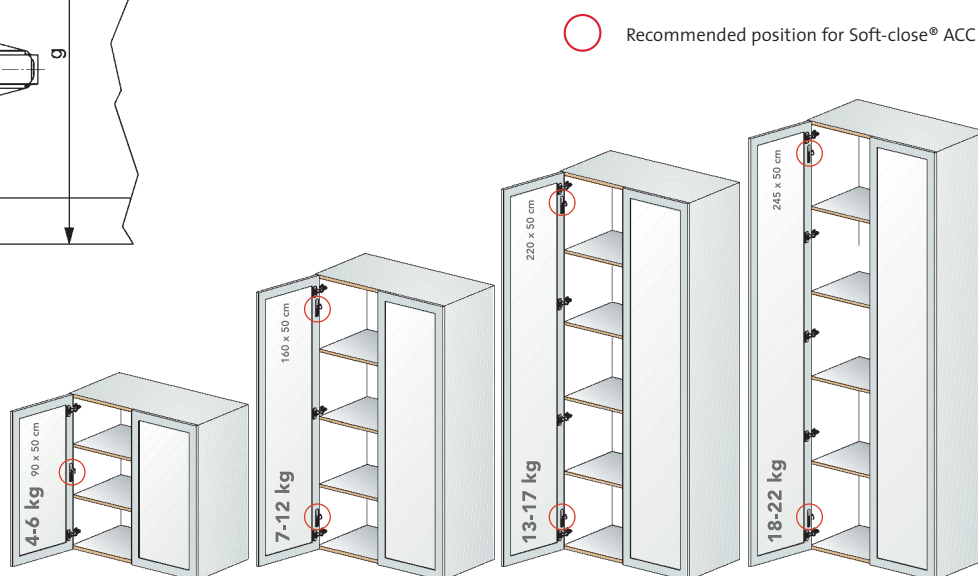

Hinge Cranking 00		(TA) 4 mm	(TA) 5 mm	(TA) 6 mm
		(K)	(K)	(K)
		9	10	11
Mounting plate thickness (f)	00	x	x	x
	02	x	x	x
	04	x	x	x
Hinge Cranking 08		(TA) 4 mm	(TA) 5 mm	(TA) 6 mm
		(K)	(K)	(K)
		4	4	4
Mounting plate thickness (f)	00	x	x	x
	02	x	x	x
	04	x	x	x
Hinge Cranking 15		(TA) 4 mm	(TA) 5 mm	(TA) 6 mm
		(K)	(K)	(K)
		4	4	4
Mounting plate thickness (f)	02	x	x	x
	04	x	x	x

Values based on door edge 1 mm radius. We recommend a trial mount.
When using wooden frames smaller than 60 mm we recommend a trial mount.
When using aluminium frames use of glass gasket or Silicon is not allowed in the area where Soft-close ACC is fitted.

○ Recommended position for Soft-close® ACC

Soft-close® AL

For aluminium frame doors

Soft-close® AL



- For aluminium frames 20 x 20 mm
- To use with CS 17 AL hinges
- Soft-close characteristic can be adjusted
- Simple assembly
- Invisible from the outside
- Elegant design



Ref. No.

924.200.37.0215

PU 125 pcs.

Cover cap



Ref. No.

514.000.85.0115

Plastic, nickel plated

514.000.86.0115

Plastic, nickel plated
with Mepla-Alfit Logo

PU 125 pcs.

Counter part, universal

suitable for use with all crankings



Ref. No.

514.200.60.0115

Zinc die-cast, nickel plated

PU 125 pcs.

Counter part

suitable for use with
cranking oo only



Ref. No.

514.300.55.0115

Steel, nickel plated

PU 125 pcs.

PU = Packing unit

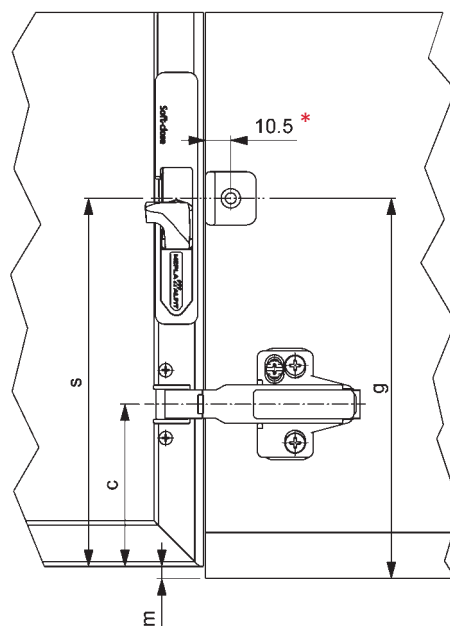
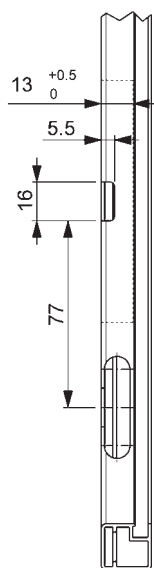
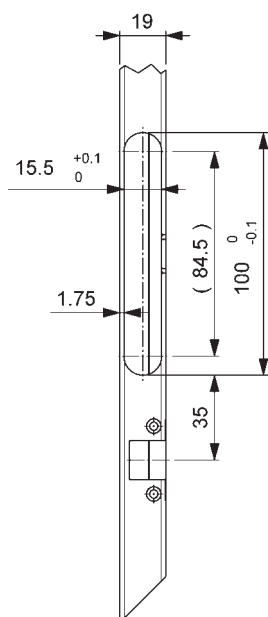

$$g = s + m$$

* Position for inset door: 10,5 mm + door thickness + 2 mm

Use of glass gasket or Silicon is not allowed in the area where Soft-close AL is fitted.
We recommend a trial mount.

○ Recommended position for Soft-close® AL

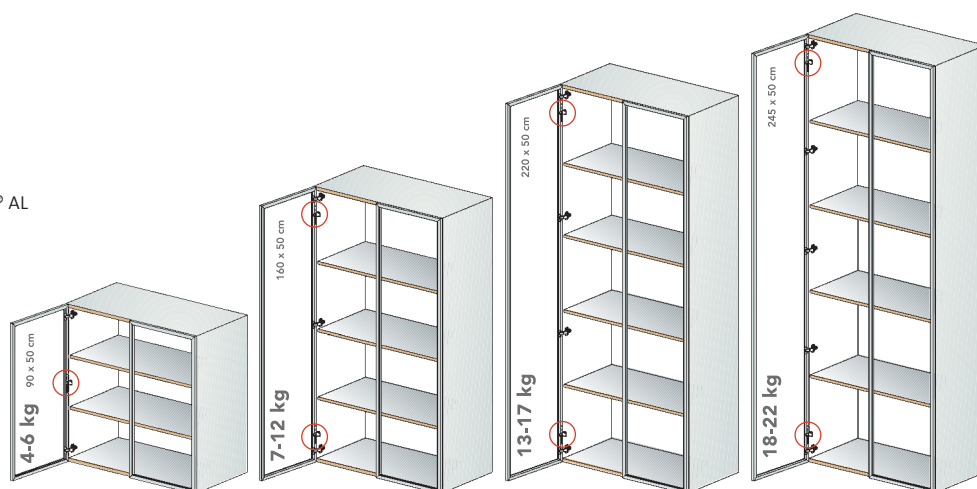

Notes

One step ahead of the future.



MEPLA  ALFIT
Feel the motion !

MEPLA-WERKE
Lautenschläger GmbH & Co. KG
Egerländer Straße 2
D-64354 Reinheim
Telefon ++49 (0) 61 62 / 8 02 - 0
Telefax ++49 (0) 61 62 / 8 02 - 181
E-Mail info@mepla-alfit.de

Alfit AG
Sennemahd 10
A-6840 Götzis
Telefon ++43 (0) 55 23 / 59 60 - 0
Telefax ++43 (0) 55 23 / 6 45 10
E-Mail info@mepla-alfit.com

www.mepla-alfit.com